

# Project - 'Save Our School'

- The school has a problem with surface water flooding
- This happens when there is too much for the drains to take away
- This can mean that school areas flood, we have to have wet play and stay indoors more often
- We need you to be surveyors for the day and assess the possible options the school could use to manage the water better

# Task 1 – Survey the school

ACTION CARD

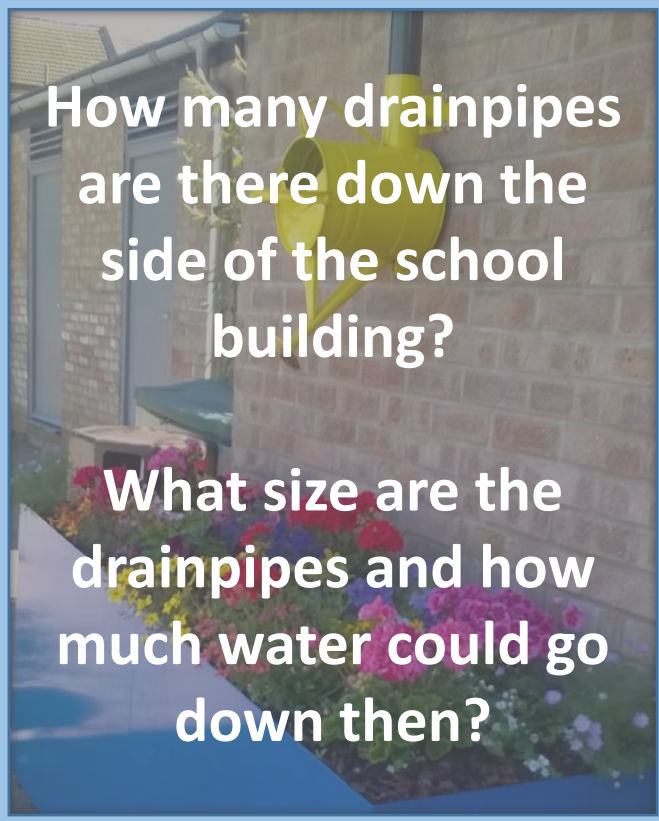

ACTION CARD

ACTION CARD

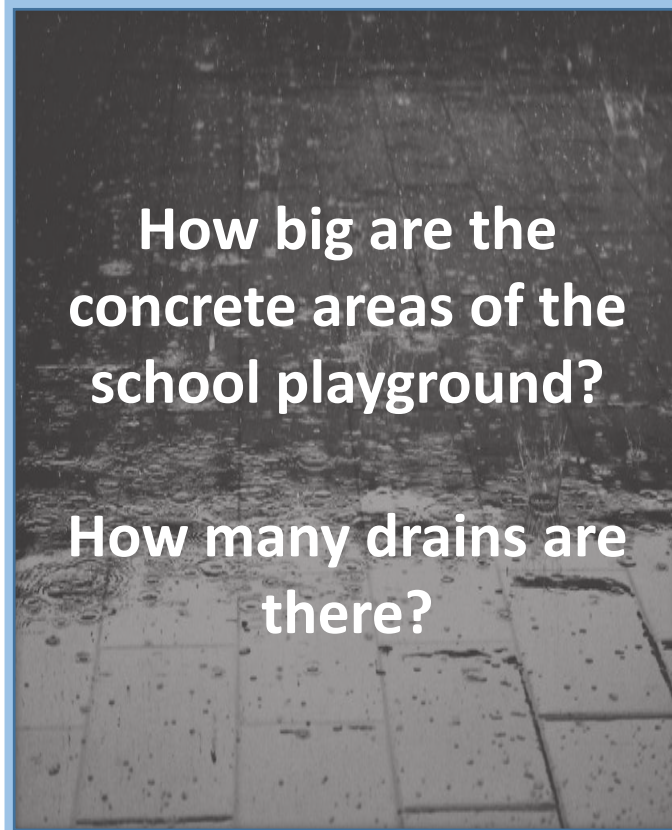

ACTION CARD

ACTION CARD

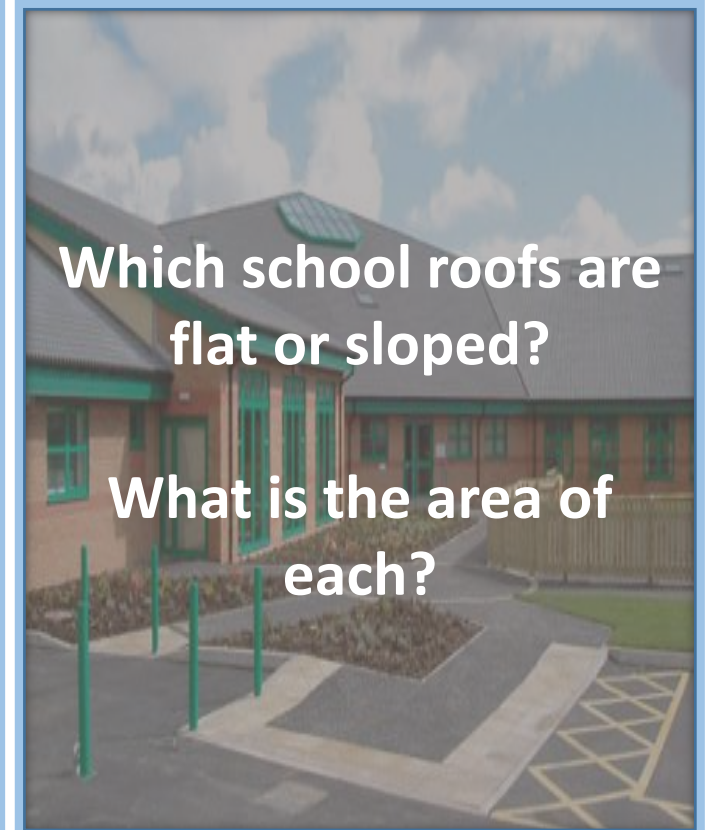

ACTION CARD

# Task 2 – What could we do

OPTIONS CARD



Do we need to clean the drains out?

OPTIONS CARD

OPTIONS CARD



Where could we plant trees?

OPTIONS CARD

OPTIONS CARD



Could we plant some of our roofs?

OPTIONS CARD

# Task 3 – Design the new school

Curriculum Links

Geography

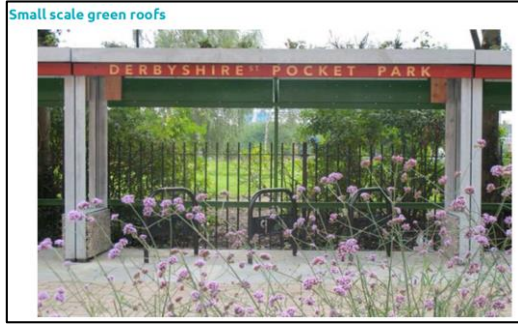

Opportunities to introduce nature based solutions on constrained sites to improve teaching and learning conditions

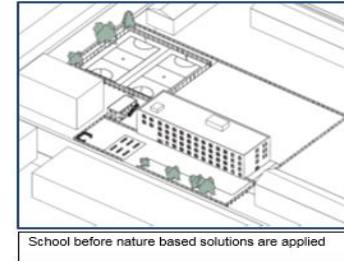
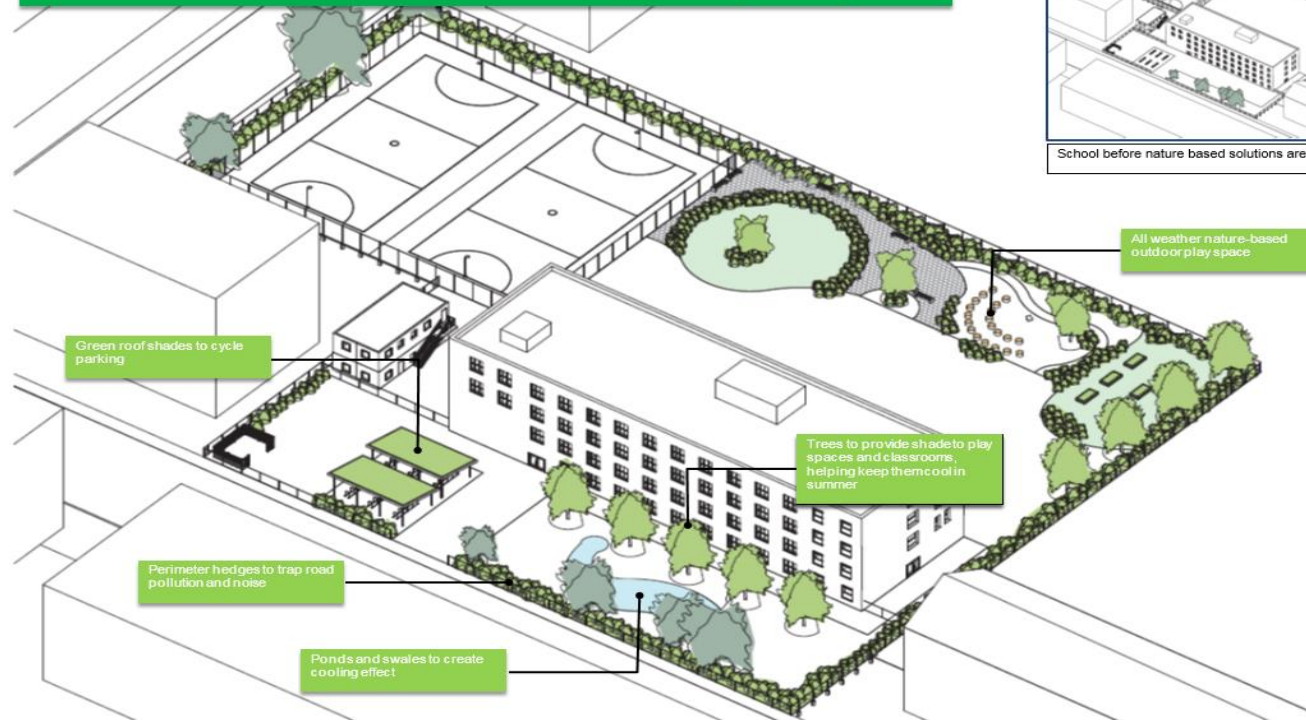

TOP DOWN VIEW

Pond depth in front of platform ~0.2m deep, and shelves evenly to provide an easy exit route for people and animals if they fall in.

Pond margin adjacent to the viewing point protected from traffic by a natural barrier allowing emergent pond plants to grow in the shallow margins.

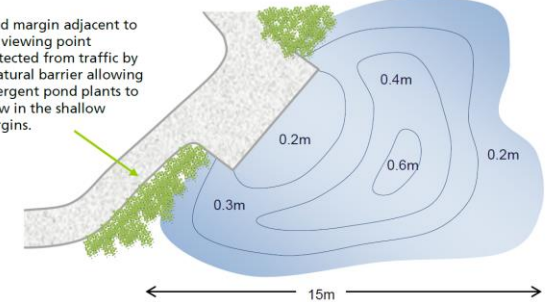

# Task 4 – What materials do we need, how much do they cost and where can we get them?

What we need	How many?	How much does it cost (google search your best options)	Where could we get the money?
Water Butts	?	?	?
Trees	?	?	

- <https://www.woodlandtrust.org.uk/plant-trees/schools-and-communities/frequently-asked-questions/>

# Task 5 – Present your plans

- To the Eco School Council
- To your class
- To the school assembly
- To the school governors